

# Smart Switch Gen3

## User Manual

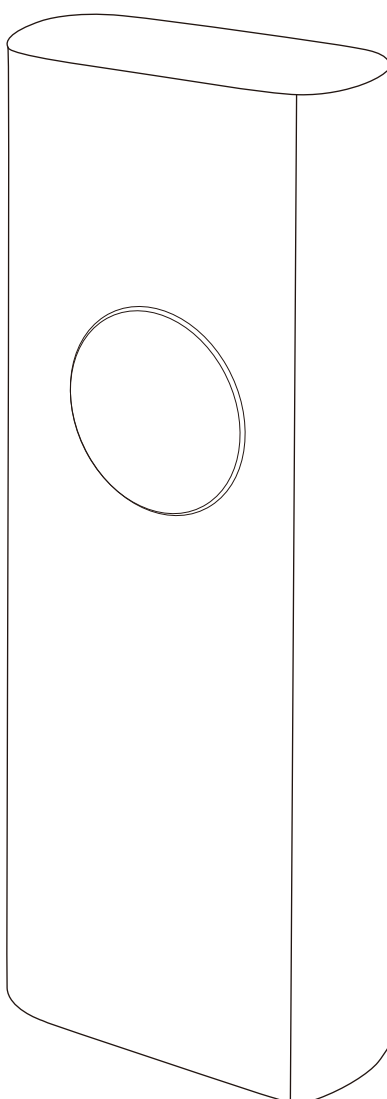

THIRD REALITY

# Contents

What' s in the box .....	01
Installation .....	02
Using your Smart Switch .....	06
LED Status .....	06
Setup with Smart Bridge MZ1 .....	07
Setup with Third Reality .....	10
Setup with SmartThings .....	12
Pairing with Hubitat .....	15
Pairing with Home Assistant .....	18
Troubleshooting .....	21
FCC Regulatory Conformance .....	24

# What's in the Box

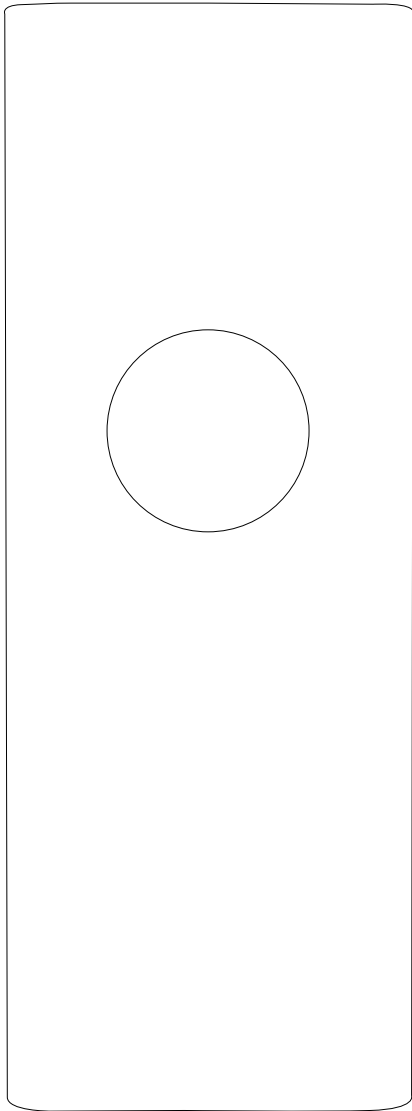

Smart Switch MT1

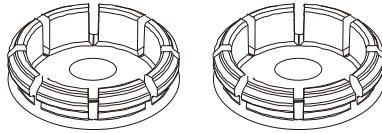

Fastener x2

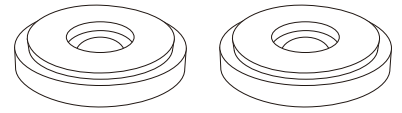

Thin Spacer x2

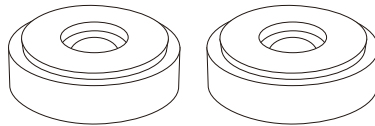

Thick Spacer x2

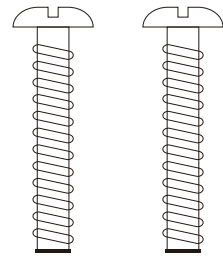

Screw x2

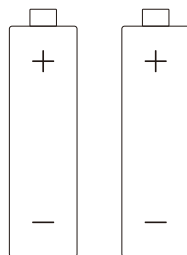

Battery x2

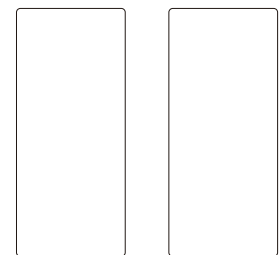

Protective Film x2

# Installation

- ① Remove screws from faceplate.

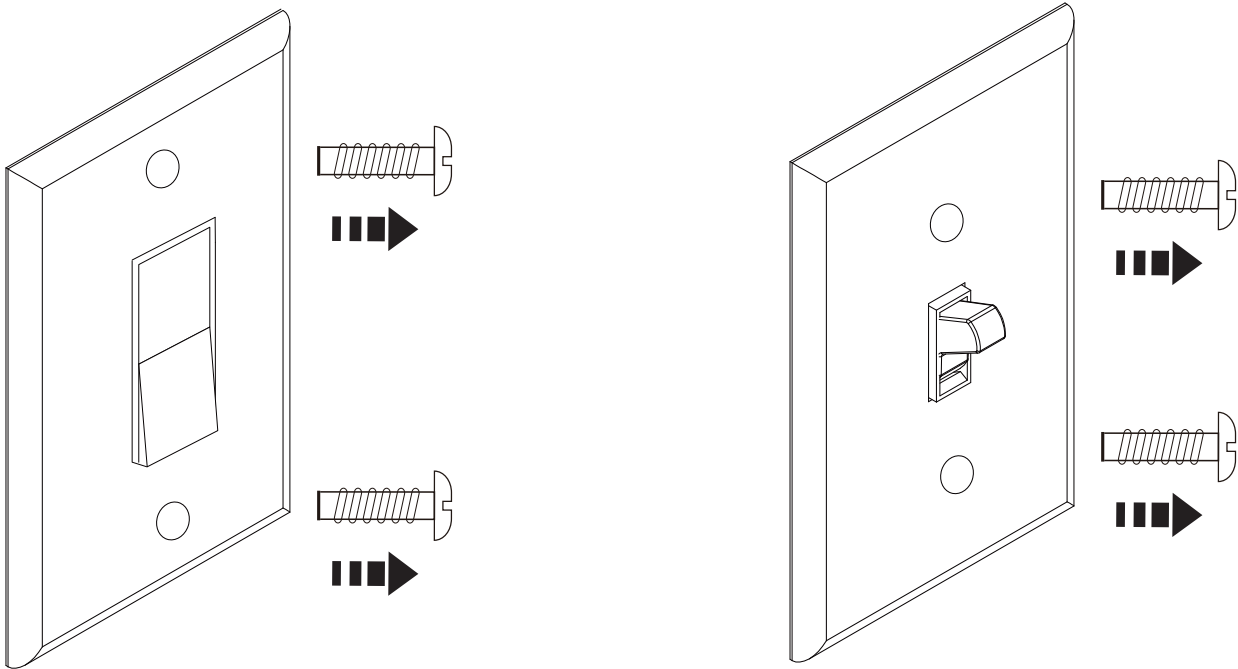

- ② For rocker switch, please select the fasteners and spacers as shown below. Start with the appropriate spacers. When you get to step 7, you may need to adjust the spacers accordingly.

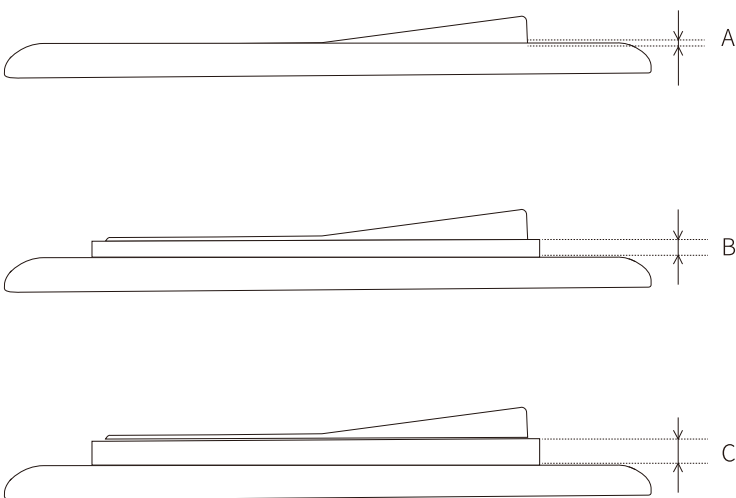

A: -0.5mm~1mm	No Spacer
B: 1mm~2.5mm	Thin Spacer
C: 2.5mm~4mm	Thick Spacer

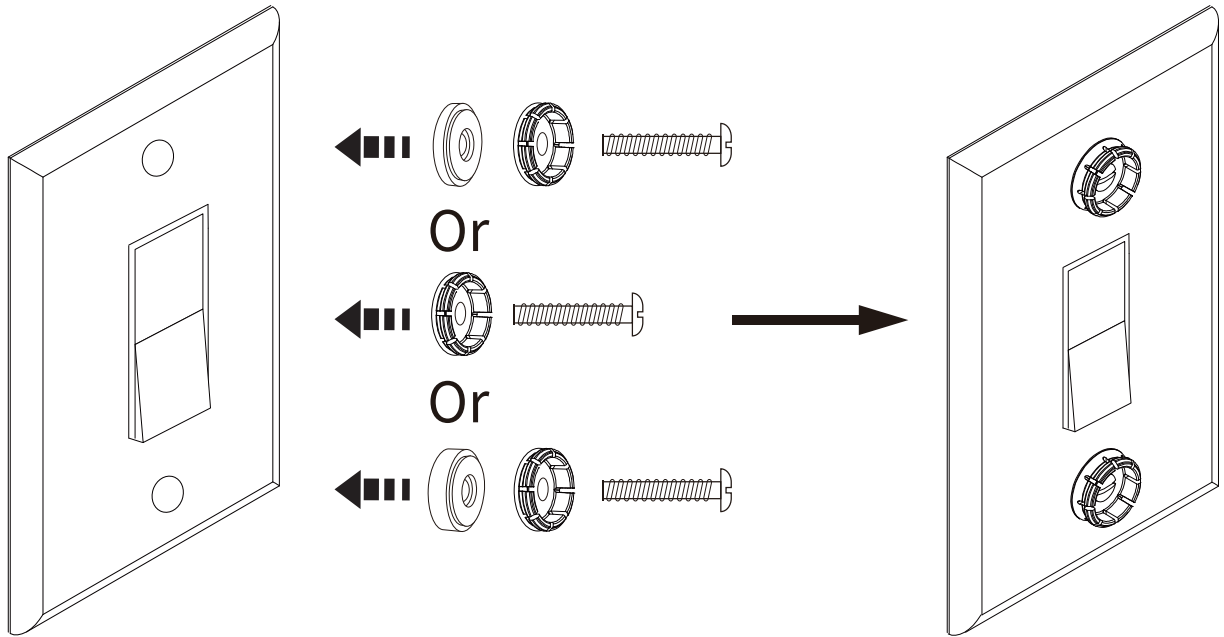

③ Insert two AAA batteries and replace cover.

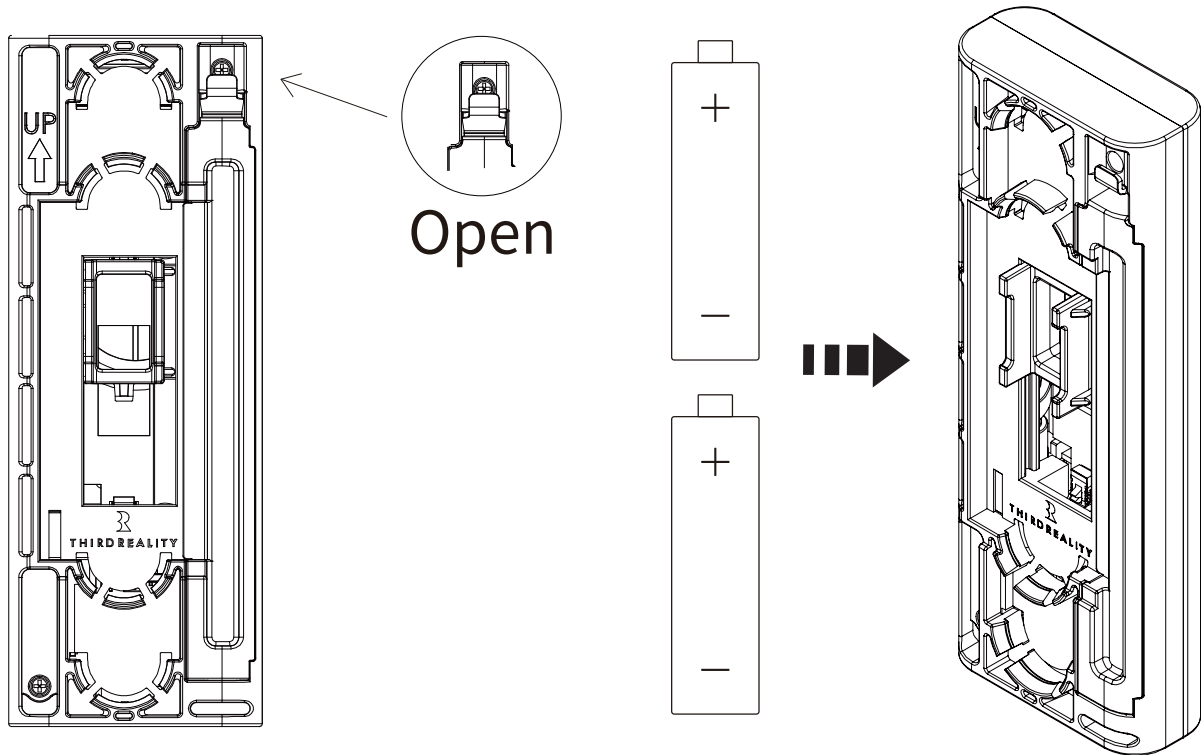

#### ④ Pairing Instructions

Note: Make sure your Echo device is up to date. You can say “Alexa, is my software up to date?” to trigger the update.

1. Bring the Smart Switch closer to your Echo device.
2. Put switch into pairing mode by holding button for at least 20 seconds, until light flashes rapidly.
3. Say “Alexa, discover my device.”

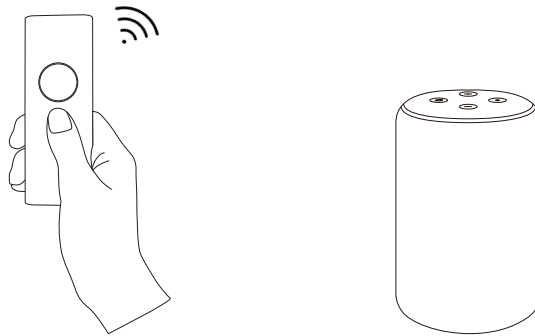

- ⑤ Make sure Smart Switch actuator is in the up position as shown by pressing the button

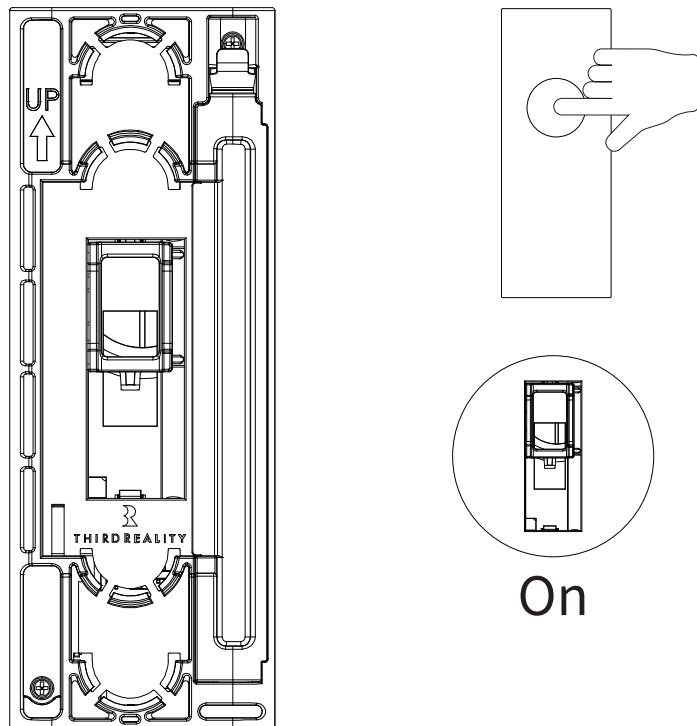

- ⑥ Turn your rocker or toggle switch ON position, as shown.

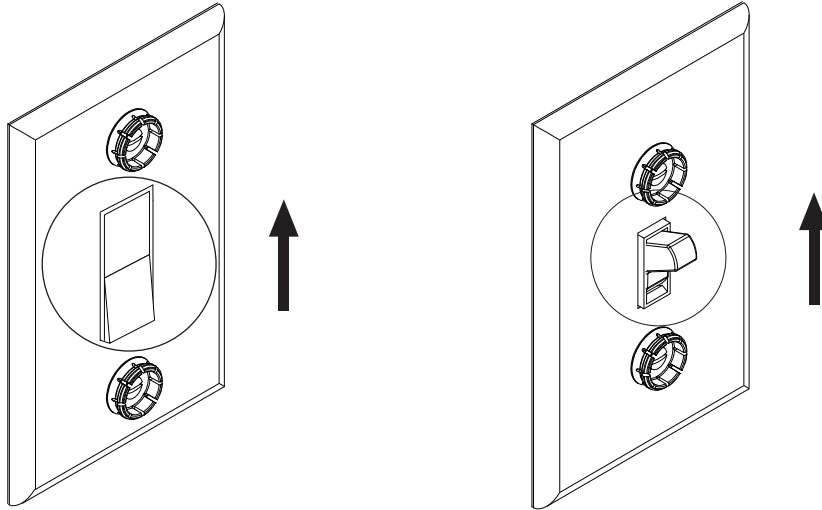

- ⑦ Place Smart Switch over existing switch. Test the switch by pressing the button to turn on and off. Adjust the spacers to ensure proper engagement between the Smart Switch and wall switch.

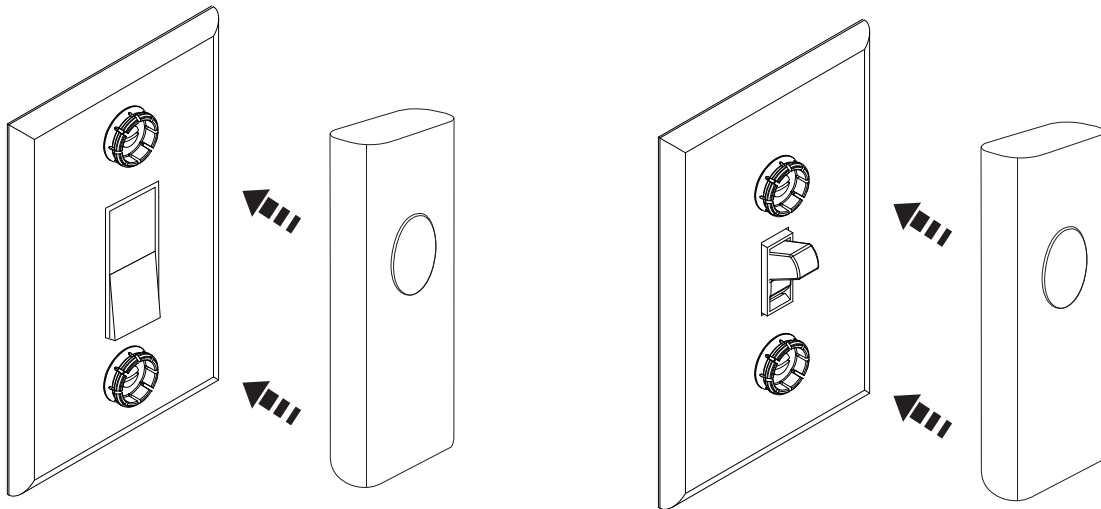

Optional- for rocker switch, place protective film over paddle, as shown.

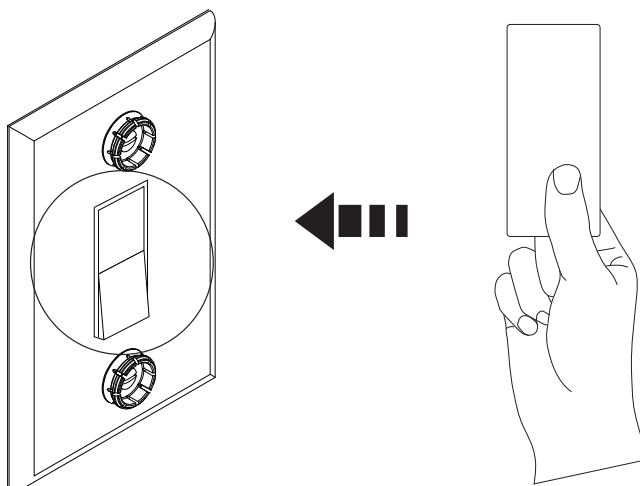

# Using your Smart Switch

1. Follow instructions in the Amazon Alexa App to set up your Amazon Echo.
2. For optimal performance, switch should be no more than 100 feet from Echo device.
3. To control device using voice commands, say “Alexa, turn on/off First Switch.

## LED Status

Pairing: LED fast blinking (two blinks every second)

Reconnect: LED slow blinking (blink once every three seconds)

Low Battery: LED double blinking (two short blinks every two seconds)

# Setup with Smart Bridge MZ1

The Smart Bridge (sold separately) enables your Zigbee device to become Matter-compatible, allowing seamless integration with major Matter ecosystems like Apple Home, Google Home, Amazon Alexa, Samsung SmartThings, and Home Assistant. By setting up your Zigbee switch with the Smart Bridge, it transforms into a Matter compatible smart switch, enabling local control through Matter. Third Reality also offers the 3R-Installer App, which lets you configure Zigbee switch attributes such as default-on behavior and perform firmware updates.

- 1) Ensure your bridge is already set up within your smart home system.
- 2) Long press the button of the switch for 30 seconds until the LED turns fast blinking, make sure it is in pairing mode.
- 3) Press the pinhole button on the bridge to activate Zigbee pairing mode. The Zigbee blue LED should start blinking.
- 4) The switches will pair with the bridge, and new devices will appear in your smart home app, such as Google Home or Alexa.
- 5) Optionally, you can install the 3R-Installer App and add N-way Switch Group by smart bridge. Then, use the multi-admin feature in your smart home app to share permissions with the 3R-Installer App.

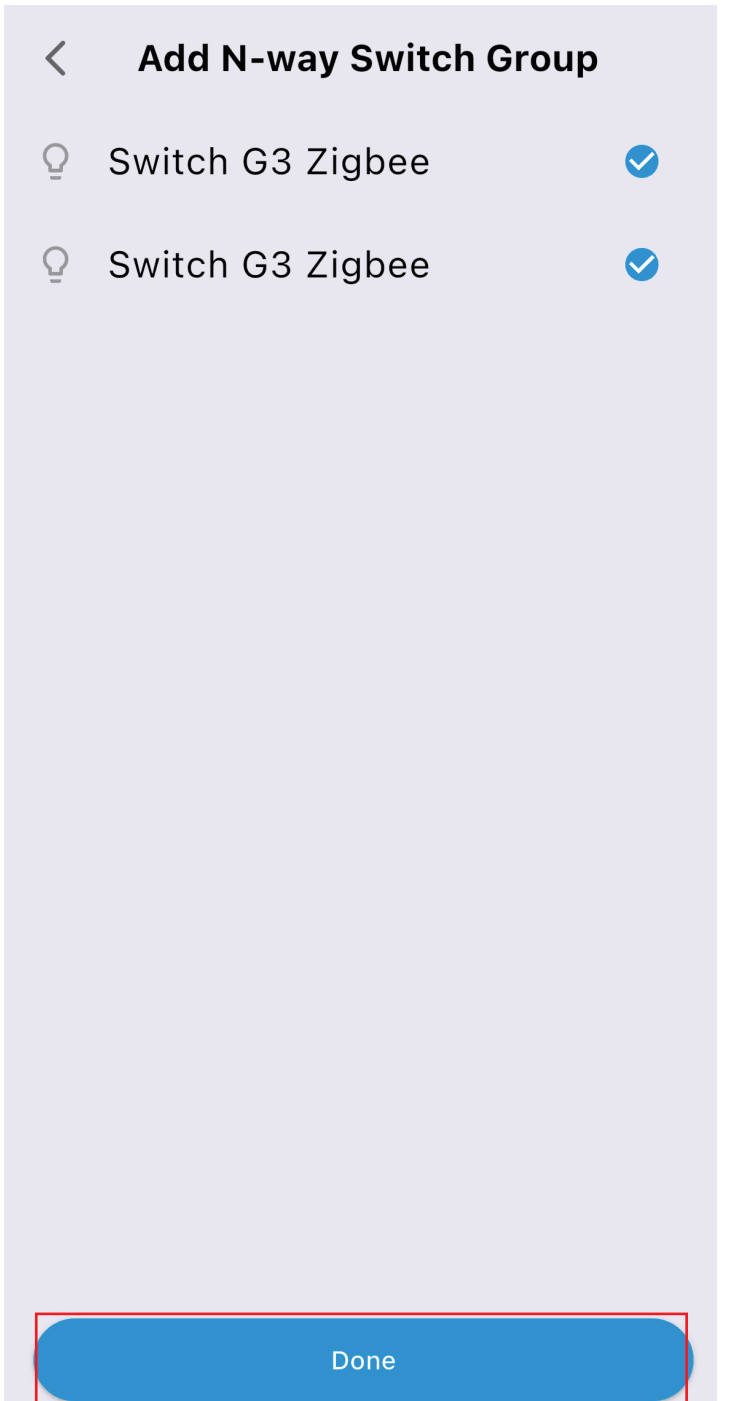
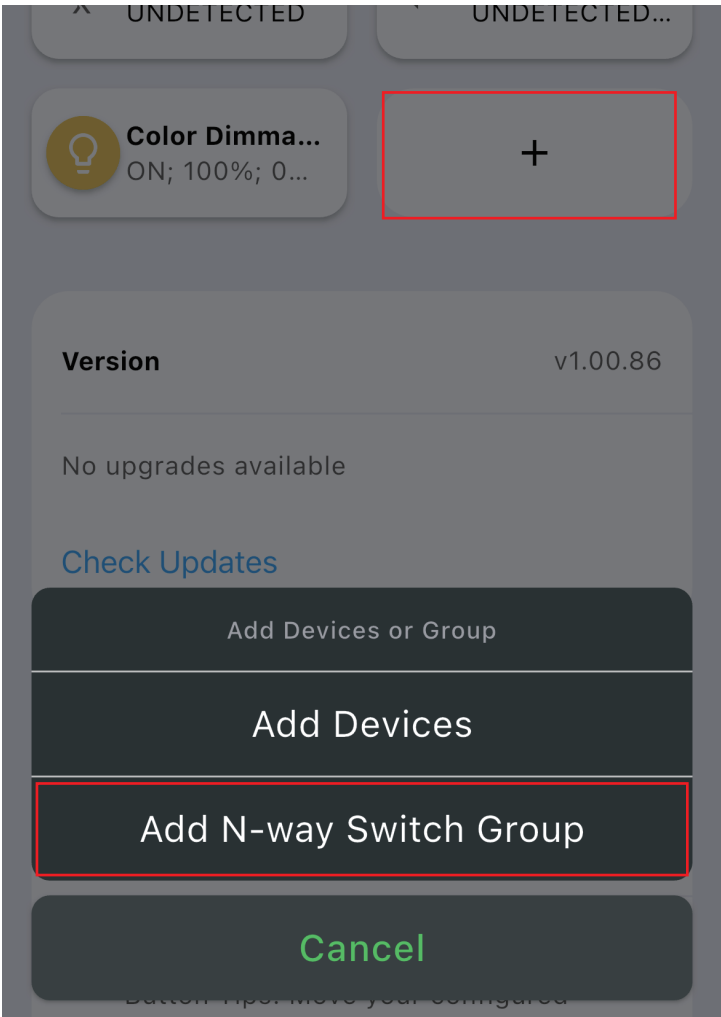
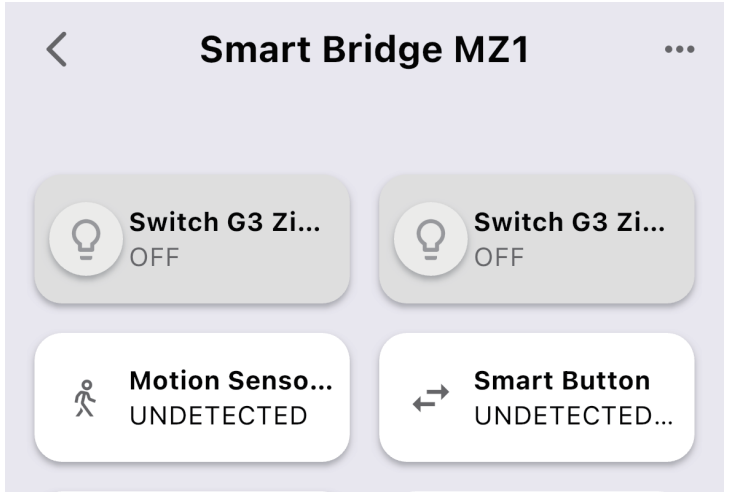
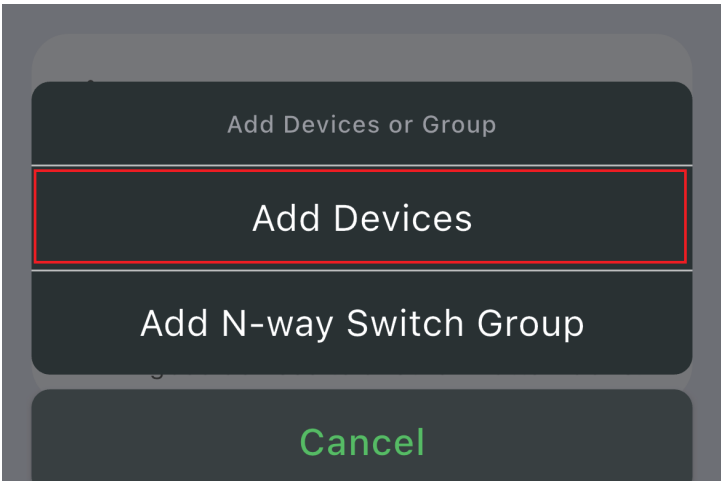

# Pairing with Third Reality

App: Third Reality App

Hub: Third Reality Smart Hub/Smart Hub Gen2 Plus



## Pairing steps:

- 1) Register and sign in your THIRDREALITY account, and add the THIR-DREALITY hub.
- 2) Long press the button of the switch for 30 seconds until the LED turns fast blinking, make sure it is in pairing mode.
- 3) Tap "+" in the right of Smart Hub to add device.
- 4) Create routines to control other connected devices.

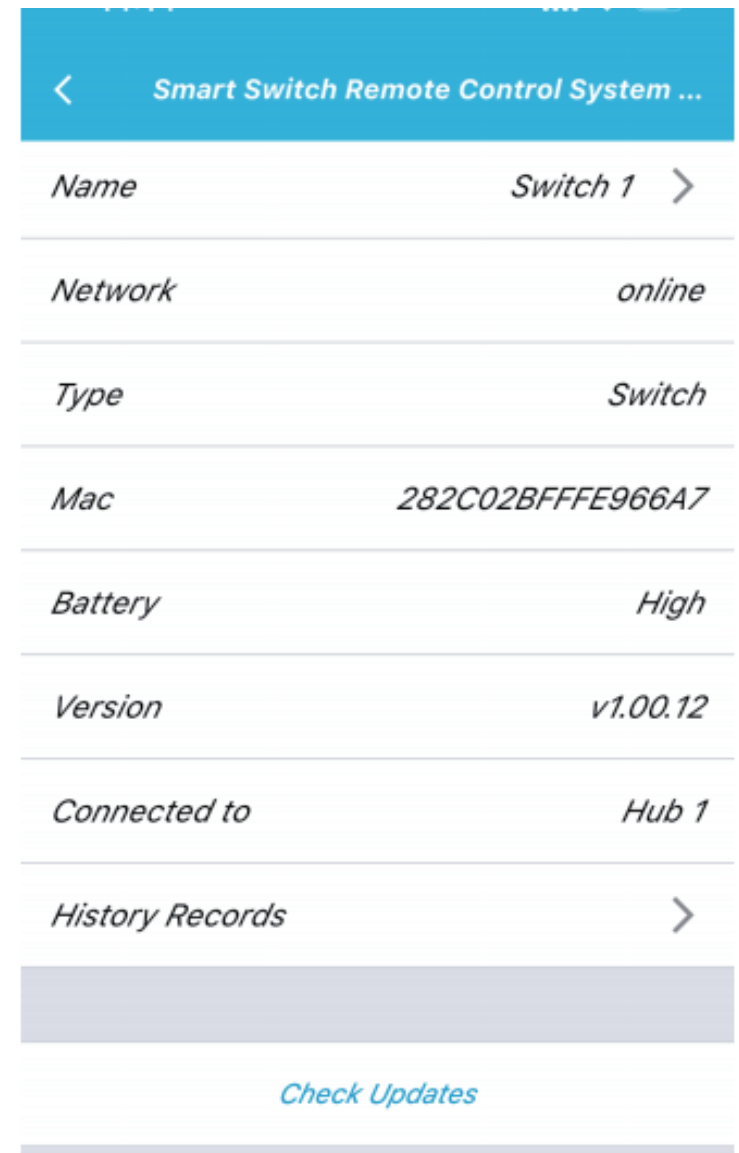
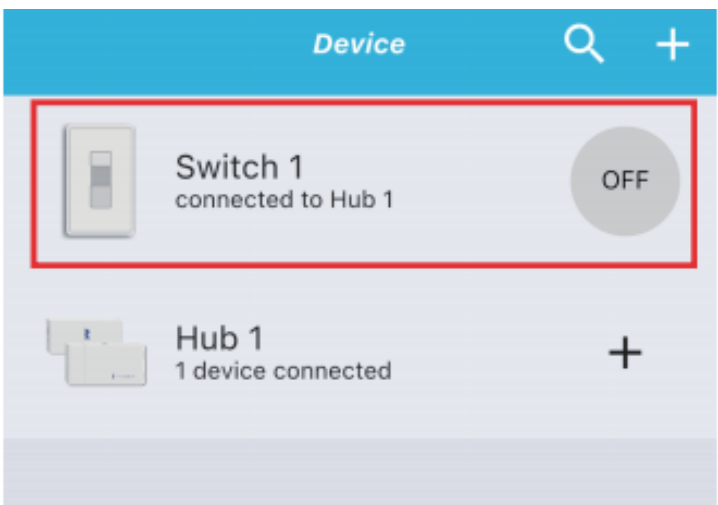
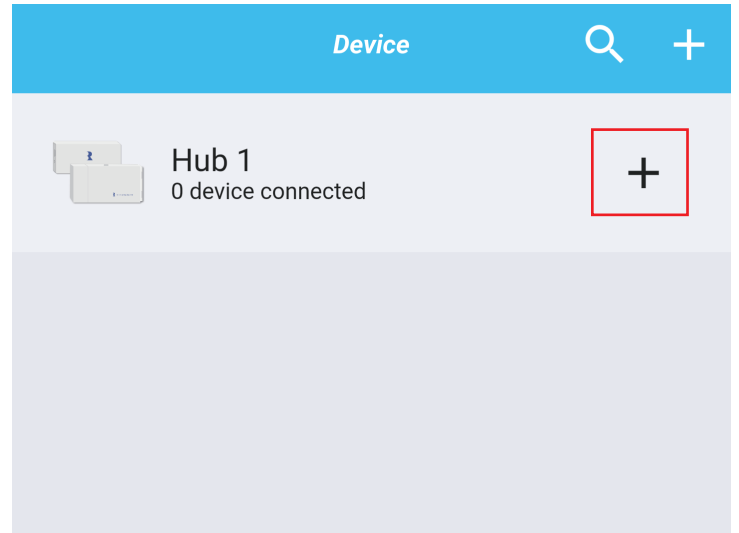
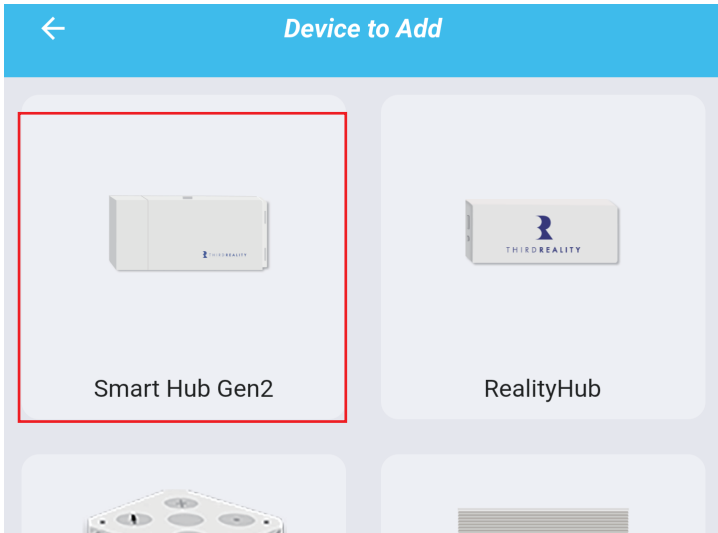



# SmartThings

## Channel Information

- Name  
Third Reality
- Description  
SmartThings driver for Third Reality devices
- [Terms of Service](#)

## My Hubs

### Aeotec Hub

My home

**Enroll**



# SmartThings

## Channel Information

- Name  
Third Reality
- Description  
SmartThings driver for Third Reality devices
- [Terms of Service](#)

## My Hubs

### Aeotec Hub

My home

Unenroll

Available Drivers



# SmartThings

## Third Reality

### Aeotec Hub

#### My home

- 
- Name  
Zigbee Switch
  - Description  
SmartThings driver for Zigbee switch devices
  - Permissions
    - zigbee: Enable full access to Zigbee actions

**Install**

- 1) Long press the button of the switch for 30 seconds until the LED turns fast blinking, make sure it is in pairing mode.
- 2) Open the SmartThings App, tap “+” on the upper right corner to “Add device” and then tap “Scan” to “Scan for nearby devices”.
- 3) The device will be paired with the SmartThings hub in a few seconds.
- 4) Create routines to control connected devices.

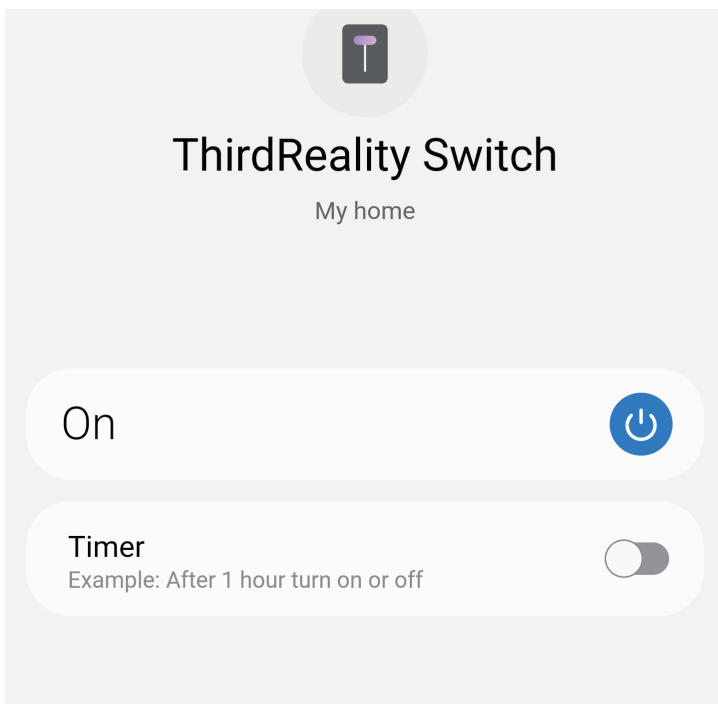
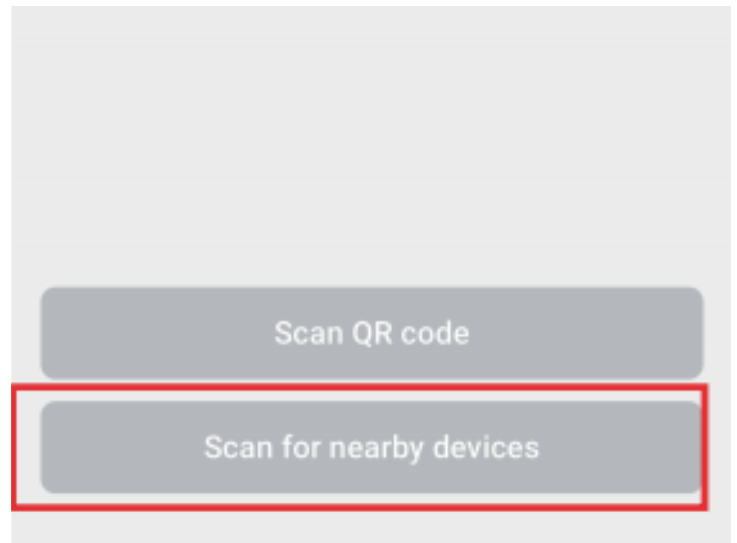
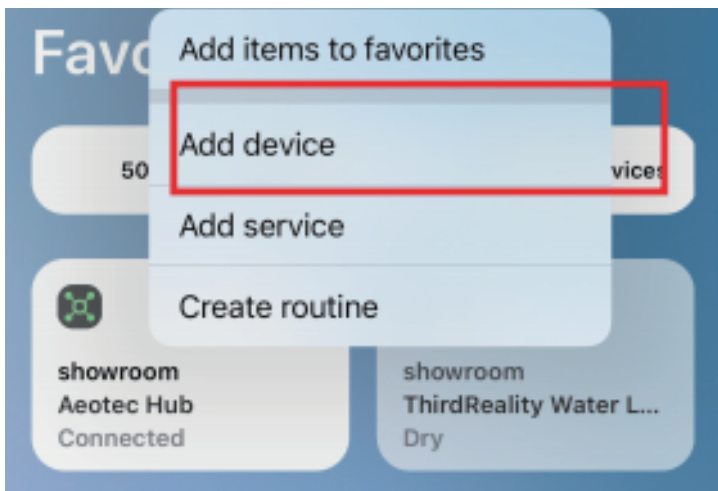

# Pairing with Hubitat

App: Third Reality App

Hub: Third Reality Smart Hub



## Pairing steps:

- 1) Tap "Add Device" in Hubitat Devices page.
- 2) Long press the button of the switch for 30 seconds until the LED turns fast blinking, make sure it is in pairing mode.
- 3) Choose "Zigbee", then "Start Zigbee Pairing".
- 4) Create a device name and room name, click "Next" to complete pairing.

The screenshot shows the Hubitat mobile app interface. The top bar displays the Hubitat logo and the title 'Devices'. A navigation sidebar on the left includes options like Rooms, Devices, Apps, Settings, Subscriptions, and Developer tools. The main content area shows a 'Compatible list' table with columns for Label (Name), Room, Type, Source, and Last Activity. The 'Add Device' button is highlighted with a red box in the top right corner of the list area.

Label (Name)	Room	Type	Source	Last Activity
0000 (Generic Zigbee Shade)		Generic Zigbee Shade	System	11-04 4:38am
1212 (Generic Zigbee Outlet)		Generic Zigbee Outlet	System	12-01 1:57am
5555 (Generic Zigbee Motion Sensor (no temp))	huan	Zigbee Motion Detector	User	12-08 9:08am
93FC (Generic Zigbee Temperature/Humidity Sensor)		Generic Zigbee Temperature/H...	System	12-09 11:12am
bt1 (Third Reality Smart Button)		Third Reality Smart Button	System	12-06 8:25pm
button 5 (Third Reality Smart Button)		Third Reality Smart Button	System	12-08 2:27pm
button11 (Third Reality Smart Button)		Third Reality Smart Button	System	7-10 11:32pm

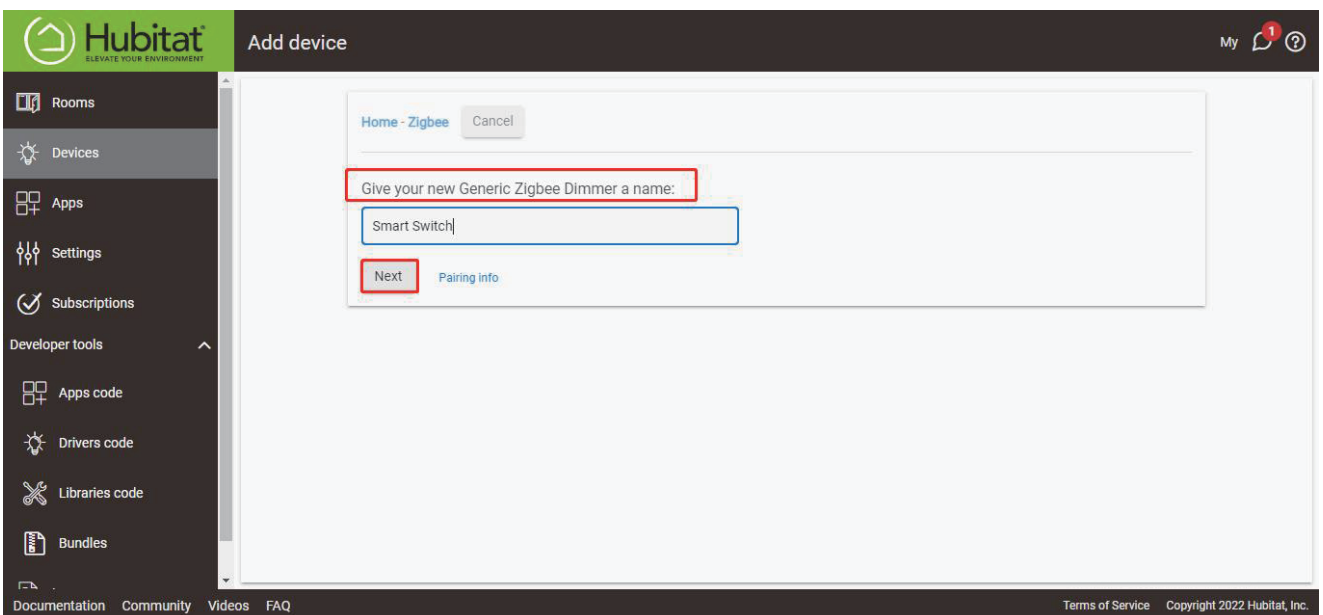
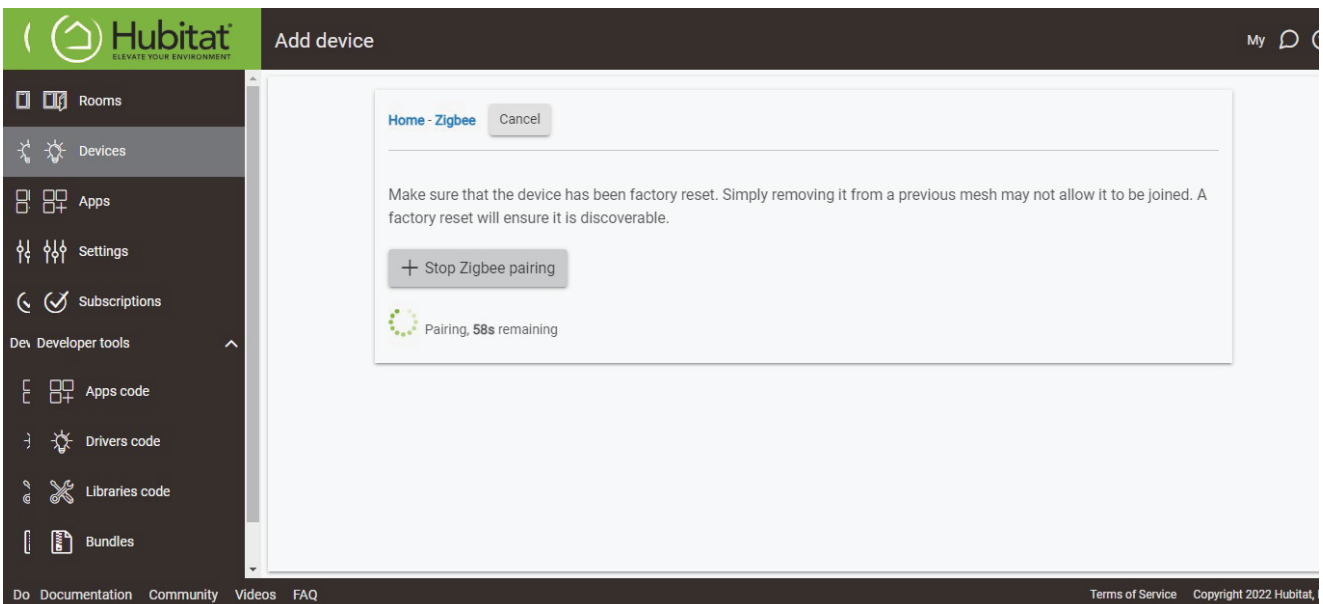
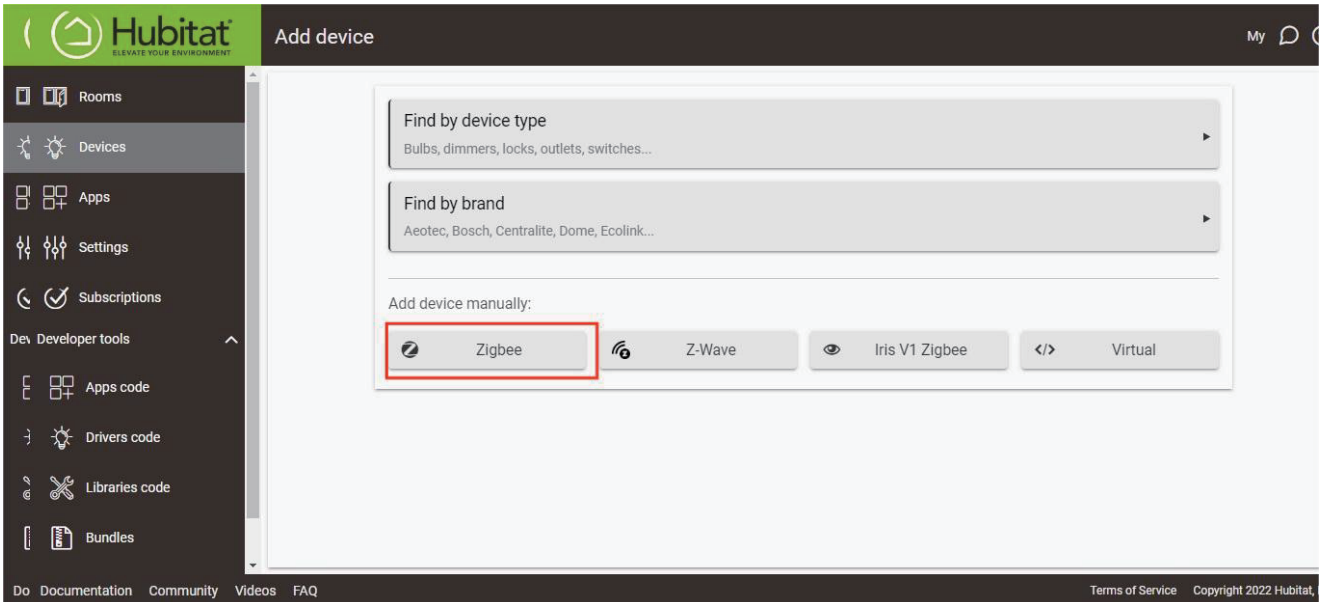

**Hubitat** ELEVATE YOUR ENVIRONMENT

# Add device

My 1 ?

- Rooms
- Devices**
- Apps
- Settings
- Subscriptions
- Developer tools
  - Apps code
  - Drivers code
  - Libraries code
  - Bundles

Home

Generic Zigbee Dimmer added!

[View device details](#)

Test the functions of your new device (**highly recommended**) and see additional details.

[+ Add another device](#)

Start from the beginning to add a new device.

Documentation Community Videos FAQ Terms of Service Copyright 2022 Hubitat, Inc.

**Hubitat** ELEVATE YOUR ENVIRONMENT

# Smart Switch

My 1 ?

- Rooms
- Devices**
- Apps
- Settings
- Subscriptions
- Developer tools
  - Apps code
  - Drivers code
  - Libraries code
  - Bundles

Device List | Events | Logs

## Commands

<b>Configure</b> configure	<b>Off</b> off	<b>On</b> on	<b>Refresh</b> refresh
<b>Set Level</b> setLevel Level* : _____ Duration : _____	<b>Start Level Change</b> startLevelChange Direction* : up	<b>Stop Level Change</b> stopLevelChange	

Current States

- switch : **off**

## State Variables

- bin : -1

Documentation Community Videos FAQ Terms of Service Copyright 2022 Hubitat, Inc.

# Pairing with Home Assistant ZHA



## Pairing steps:

- 1) Long press the button of the switch for 30 seconds until the LED turns fast blinking, make sure it is in pairing mode.
- 2) Make sure Home Assistant Integrations Zigbee Home Automation Setup is ready, then go to “Configuration” page, click “integration”.
- 3) Click “Devices” on the Zigbee item, then click “Add Devices”.
- 4) After the pairing is completed, it will show up in the page.
- 5) Back to “Devices” page, then you can find the device added.
- 6) Click to enter in the control interface to set the device.
- 7) Click “+” belongs to Automation and then you can add different actions.

Settings

- Overview
- Energy
- Map
- Logbook
- History
- Zigbee2mqtt
- Media
- Developer Tools
- Settings** 7
- Notifications 1
- jsy

- Home Assistant Core Update  
Home Assistant Core 2022.10.2
- Home Assistant Cloud  
Control home when away and integrate with Alexa and Google Assistant
- Devices & Services**  
Integrations, devices, entities and helpers
- Automations & Scenes  
Automations, scenes, scripts and blueprints
- Areas & Zones  
Manage locations in and around your house
- Add-ons  
Run extra applications next to Home Assistant
- Dashboards  
Organize how you interact with your home
- Tags

Integrations

Search integrations

- Discovered: hci0 (B8:27:EB:9C:F2:9E) Bluetooth
- Discovered: MiWiFi router UPnP/IGD
- Discovered: HubZ Smart Home Controller Z-Wave
- Discovered: MQTT
- Discovered: Tuya
- Discovered: Google Cast (2 devices and 2 entities)
- Discovered: Raspberry Pi Power Supply Checker (1 entity)
- Discovered: Sun
- HubZ Smart Home Controller - HubZ... Zigbee Home Automation (12 devices and 57 entities)

**+ ADD INTEGRATION**

Devices

Filtering by integration "Zigbee Home Automation: HubZ Smart Home Controller - HubZ ZigBee Com Port, s/n: 81300B90 - Silicon Labs" **CLEAR**

Device	Manufacturer	Model	Area	Integration	Battery
Third Reality, Inc 3RDS17BZ	Third Reality, Inc	3RDS17BZ	-	Zigbee Home Automa...	-
Third Reality, Inc 3RSB015BZ	Third Reality, Inc	3RSB015BZ	-	Zigbee Home Automa...	74 %
Third Reality, Inc 3RSB015BZ	Third Reality, Inc	3RSB015BZ	-	Zigbee Home Automa...	62 %
Third Reality, Inc 3RSB22BZ	Third Reality, Inc	3RSB22BZ	-	Zigbee Home Automa...	-
Third Reality, Inc 3RSS009Z	Third Reality, Inc	3RSS009Z	-	Zigbee Home Automa...	-
Third Reality, Inc 3RSS009Z	Third Reality, Inc	3RSS009Z	-	Zigbee Home Automa...	-
Third Reality, Inc 3RWS18BZ	Third Reality, Inc	3RWS18BZ	-	Zigbee Home Automa...	-
Zigbee Coordinator	ZHA	EZSP = Silicon Labs E...	-	Zigbee Home Automa...	-

**+ ADD DEVICE**

Home Assistant

Network Groups Visualization SHOW LOGS

Searching for Zigbee devices...

Initialization Complete

The device is ready to use

Third Reality, Inc 3RSS009Z

3RSS009Z  
by Third Reality, Inc

Change device name

Third Reality, Inc 3RSS009Z

Integrations **Devices** Entities Helpers

Search devices Filtering by integration "Zigbee Home Automation: HubZ Smart Home Controller - HubZ ZigBee Com Port, s/n: 81300B90 - Silicon Labs" CLEAR

Device	Manufacturer	Model	Area	Integration	Battery
sengled E11-N1EA	sengled	E11-N1EA	卧室	Zigbee Home Automa...	-
SmartThings outletv4	SmartThings	outletv4	卧室	Zigbee Home Automa...	-
Third Reality, Inc 3RDS17BZ	Third Reality, Inc	3RDS17BZ	-	Zigbee Home Automa...	-
Third Reality, Inc 3RSB015BZ	Third Reality, Inc	3RSB015BZ	-	Zigbee Home Automa...	74 %
Third Reality, Inc 3RSB015BZ	Third Reality, Inc	3RSB015BZ	-	Zigbee Home Automa...	62 %
Third Reality, Inc 3RSB22BZ	Third Reality, Inc	3RSB22BZ	-	Zigbee Home Automa...	-
Third Reality, Inc 3RSS009Z	Third Reality, Inc	3RSS009Z	-	Zigbee Home Automa...	-
Third Reality, Inc 3RSS009Z	Third Reality, Inc	3RSS009Z	-	Zigbee Home Automa...	-
Third Reality, Inc 3RTHS24BZ	Third Reality, Inc	3RTHS24BZ	-	Zigbee Home Automa...	-

+ ADD DEVICE

# Troubleshooting

## 1) Inverted On/Off status

To reverse On/Off direction of the switch, long press the Smart Switch button more than 10 seconds until blue LED is displayed solid then release.

## 2) Factory Reset

To factory reset the Smart Switch, press and hold the Smart Switch button more than 20 seconds until the blue LED flashed rapidly, indicating that the Smart Switch is in pairing mode now.

## 3) Adjusting/Adding Spacers

\*If the Smart Switch actuates but is not turning your wall switch on or off, the gap between Smart Switch and wall switch may be too wide. Try slightly tightening faceplate screws. You can also try using a different size spacer.

\* If Smart Switch fails to actuate or comes off the wall when actuating, the Switch may be too close to the wall. Try changing the size of your spacer.

4) Switch won't pair.

Make sure your Echo speaker is compatible with Smart Switch, Compatible Echo speakers include Echo Plus Gen 1& Gen 2, Echo Gen 4, Echo Studio.

\*Make sure your Echo device is up to date. You can say "Alexa, is my software up to date?" to trigger the update.

\*Reboot the Echo speaker by unplugging the power and plugging it back in, then try to pair the Smart Switch with it again.

\*Factory reset the Echo speaker (Press and hold the Action button for 25 seconds. The light ring will pulse orange, then turn off. Wait for the light ring to turn back on and turn blue. The light ring then turns orange again and the device enters the set up mode), then try to pair the Smart Switch with it again.

5) Smart Switch is not responding

\*Turn the Smart Switch on/off twice in the Alexa app to sync the switch.

\*If your switch is not responding, reboot your Echo speaker, factory reset the switch and pair the switch again.

\*If the switch is still not responding, try de-registering your Echo speaker using the Alexa app, set up the speaker again and pair the switch.

6) Moving Switches

If you want to change the Echo speaker that a switch is paired to, remove the switch using the Alexa app, wait 30 minutes for Alexa cloud to update and pair the switch to the new Echo speaker.

Scan this QR code to find more useful videos:



# FCC regulatory conformance

This device complies with part 15 of the FCC rules. Operation is subject to the following two conditions: (1) this device may not cause harmful interference, and (2) this device must accept any interference received, including interference that may cause undesired operation.

Changes or modifications not expressly approved by the party responsible for compliance could void the user's authority to operate the equipment.

NOTE: This equipment has been tested and found to comply with the limits for a Class B digital device, pursuant to part 15 of the FCC Rules. These limits are designed to provide reasonable protection against harmful interference in a residential installation.

This equipment generates uses and can radiate radio frequency energy and, if not installed and used in accordance with the instructions, may cause harmful interference to radio communications. However, there is no guarantee that interference will not occur in a particular installation. If this equipment does cause harmful interference to radio or television reception, which can be determined by turning the equipment off and on, the user is encouraged to try to correct the interference by one or more of the following measures:

- Reorient or relocate the receiving antenna.
- Increase the separation between the equipment and receiver.
- Connect the equipment into an outlet on a circuit different from that to which the receiver is connected.
- Consult the dealer or an experienced radio/TV technician for help important announcement.

NOTE: The manufacturer is not responsible for any radio or TV interference caused by unauthorized modifications to this equipment. Such modifications could void the user's authority to operate the equipment.

## **RF Exposure**

This equipment complies with FCC radiation exposure limits set forth for an uncontrolled environment.

This transmitter must not be co-located or operating in conjunction with any other antenna or transmitter.

## **Limited Warranty**

For limited warranty, please visit <https://3reality.com/faq-help-center/>. For customer support, please contact us at [info@3reality.com](mailto:info@3reality.com) or visit [www.3reality.com](http://www.3reality.com).

For question on other platforms, visit for corresponding platform's application/support platforms.

# Pairing with SmartThings

App: SmartThings App

Devices: SmartThings Hub 2nd Gen(2015) and 3rd Gen.(2018), Aeotec Smart Home Hub.





## Pairing steps:

- 1) Check for updates to make sure the SmartThings Hub firmware is up to date before pairing.
- 2) Add SmartThings drivers for Smart Switch Gen3
  - Open this link in your PC browser. Log in your SmartThings Account.  
<https://bestow-regional.api.smartthings.com/invite/adMKr50EXzj9>
  - Click "Enroll" --"Available Drivers" -- "Install" to install the Zigbee Contact driver.

 **N-way Switc...**  
ON

 **Motion Senso...**  
UNDETECTED

 **Smart Button**  
UNDETECTED...

 **Color Dimma...**  
ON; 100%; 0...

**+**

**Version** v1.00.86

No upgrades available

[Check Updates](#)

 **ON**

 **Switch G3 Zi...**  
OFF

 **Switch G3 Zi...**  
OFF

**+**

**Battery** 54%

[Check Updates](#)

 **Change Zigbee Channel** **15**

 **Link with Matter Enabled Services**

 **Matter Reset**

Button Tips: Move your configured

1471-224-3706 